

21

21

21

mamba

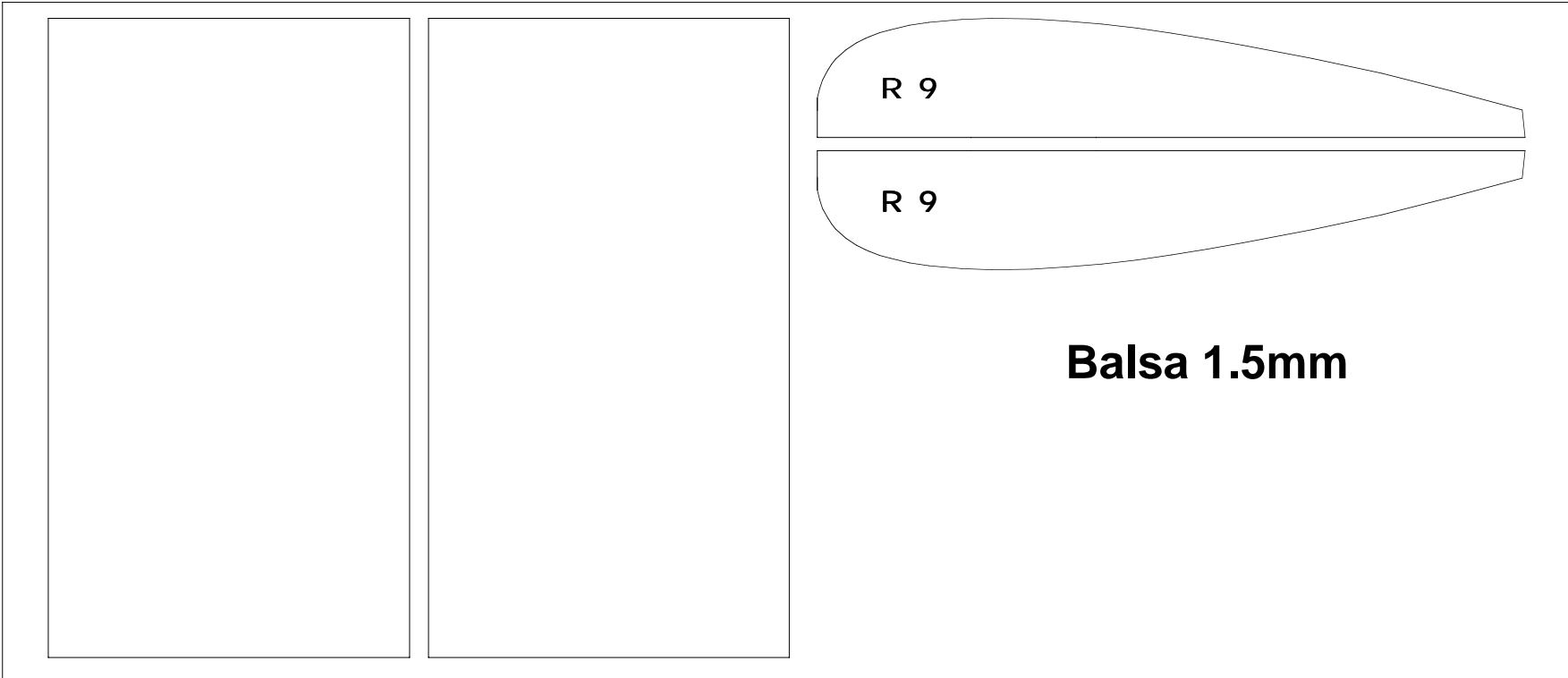

Balsa 1.5mm

Balsa 2mm

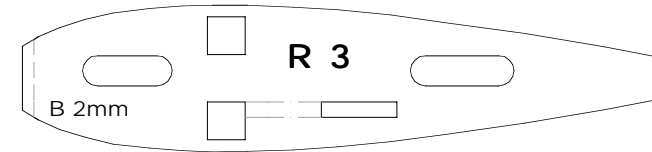
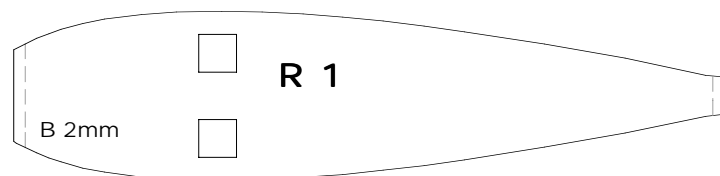
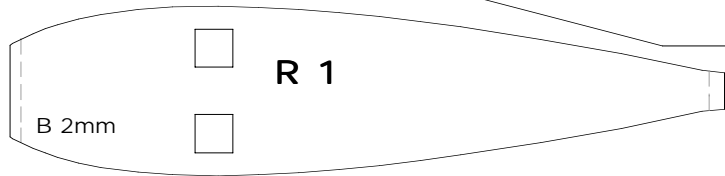
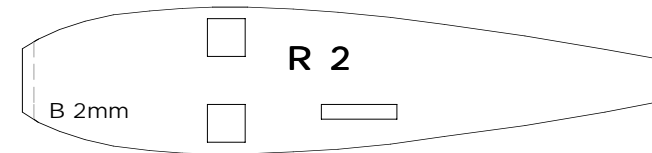
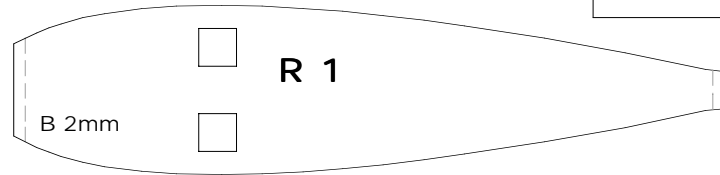
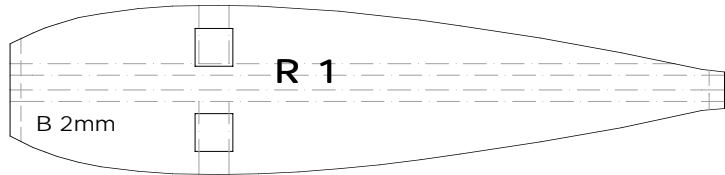
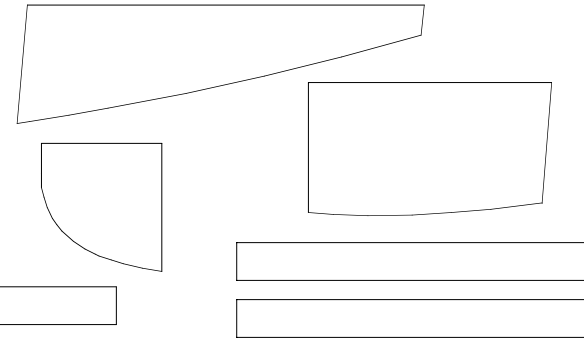
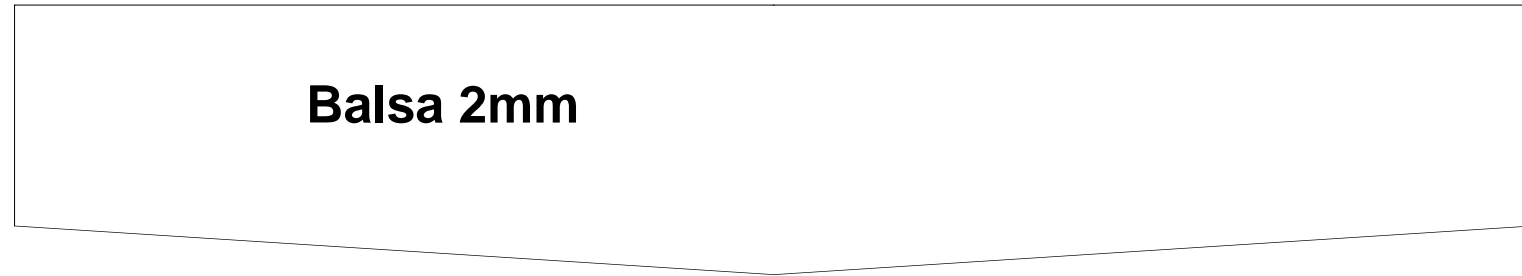

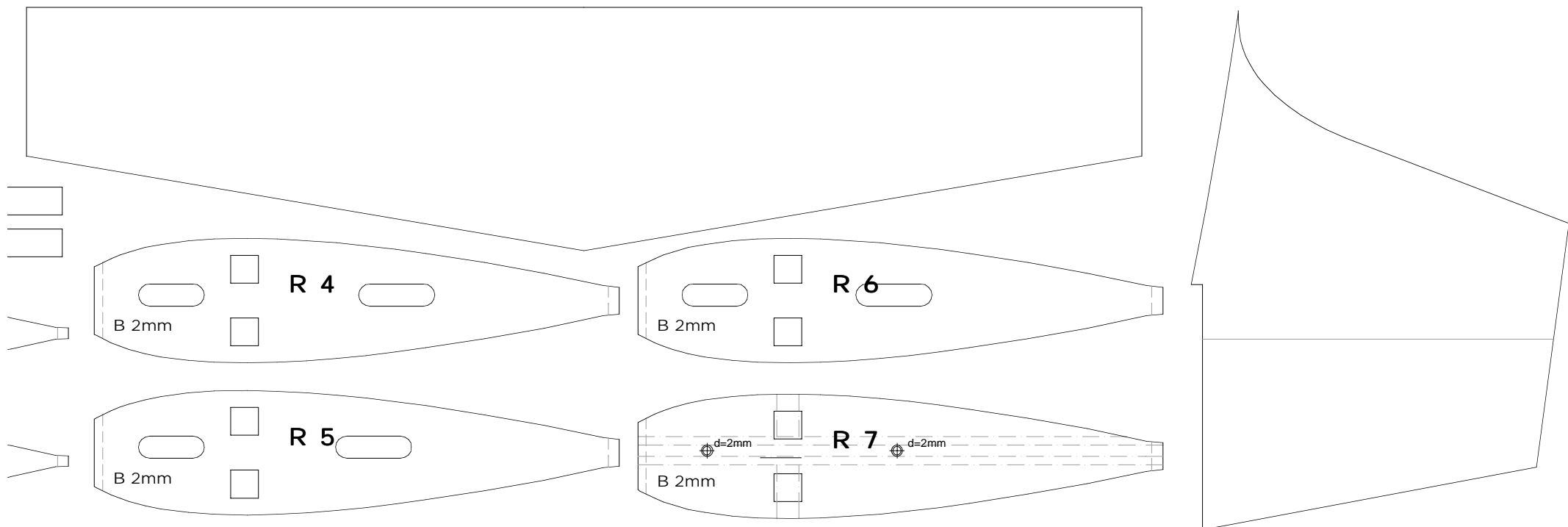

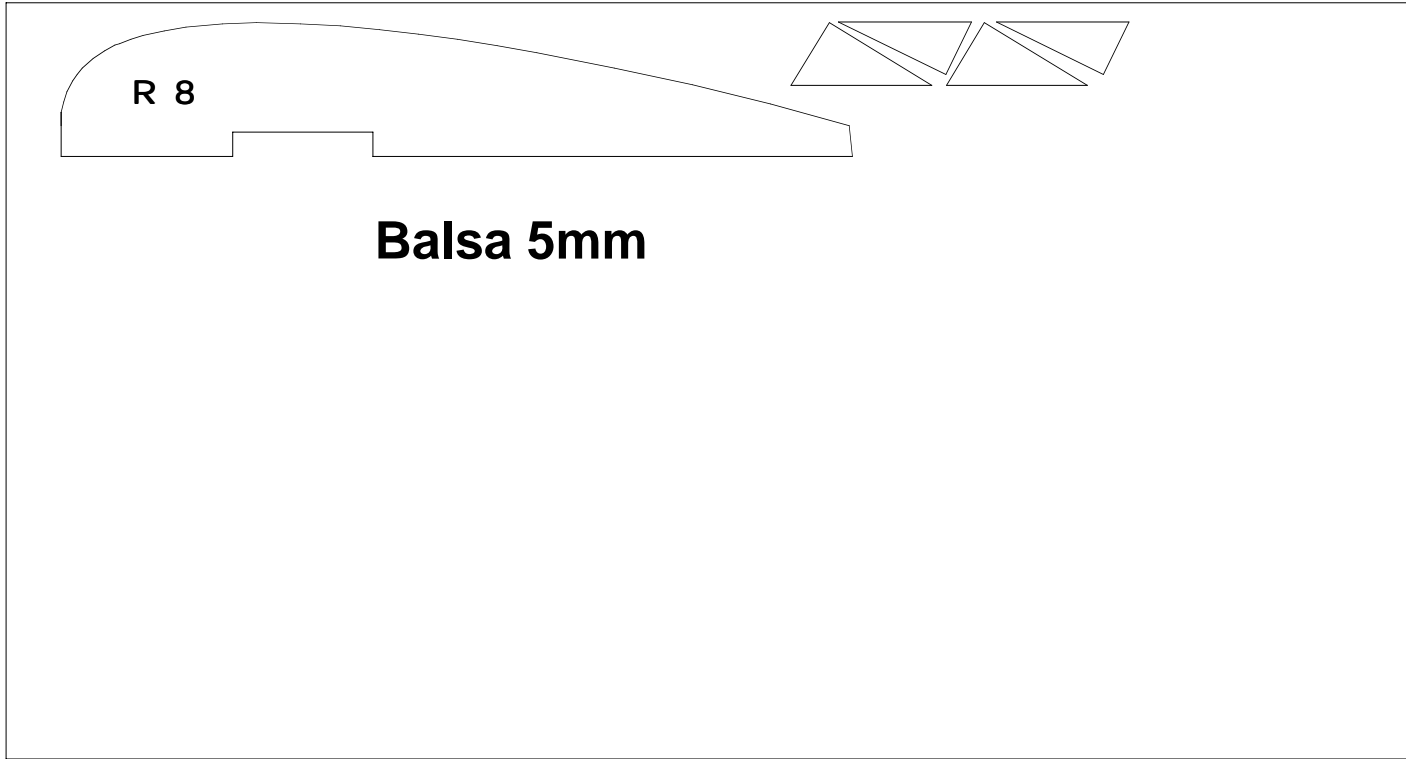

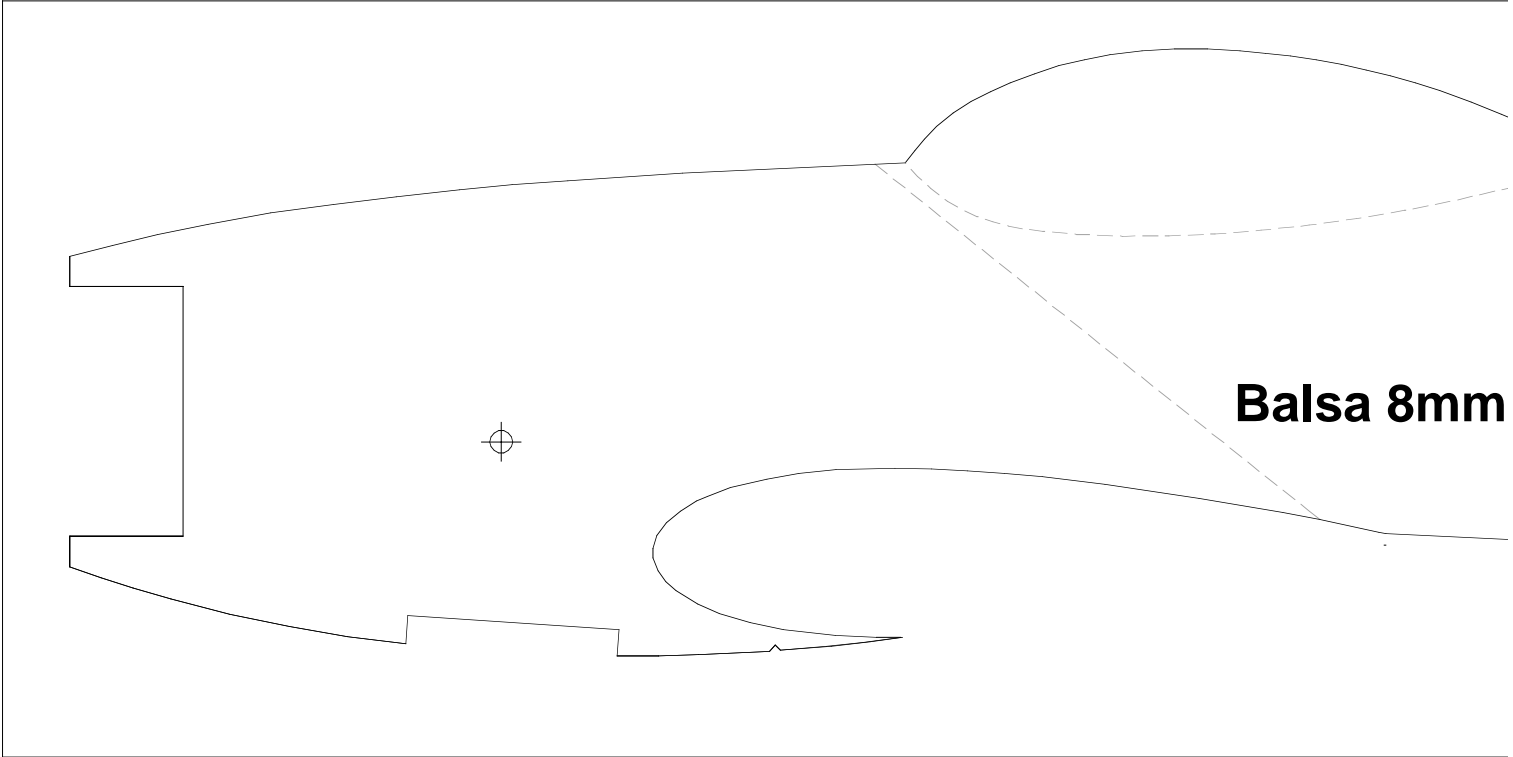

Balsa 8mm

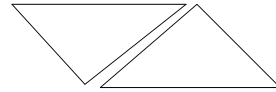

seitl- Aussteifung Motorträger 4° Seitenzug

Rumpf aus Balsabrett B 8mm

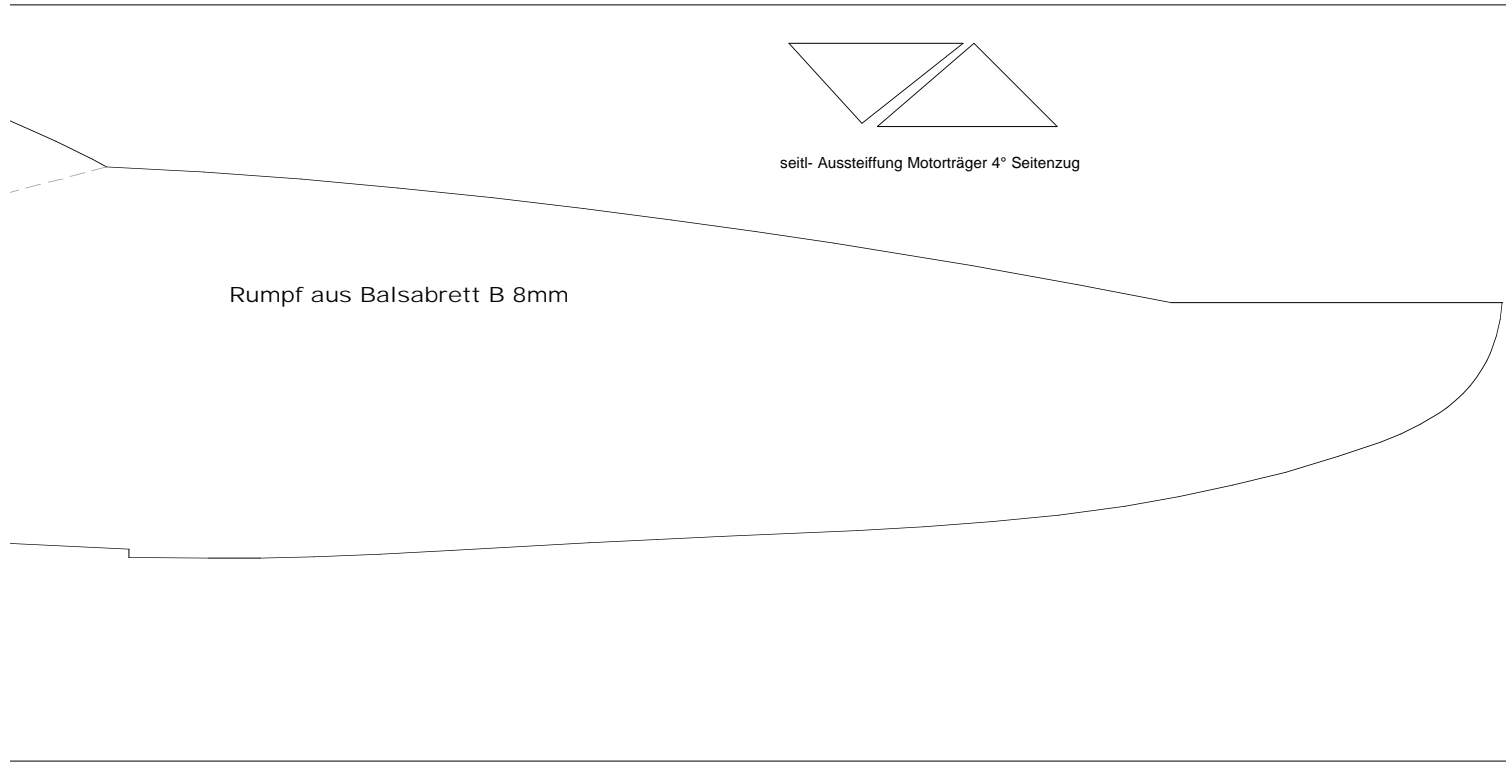

Sperrt

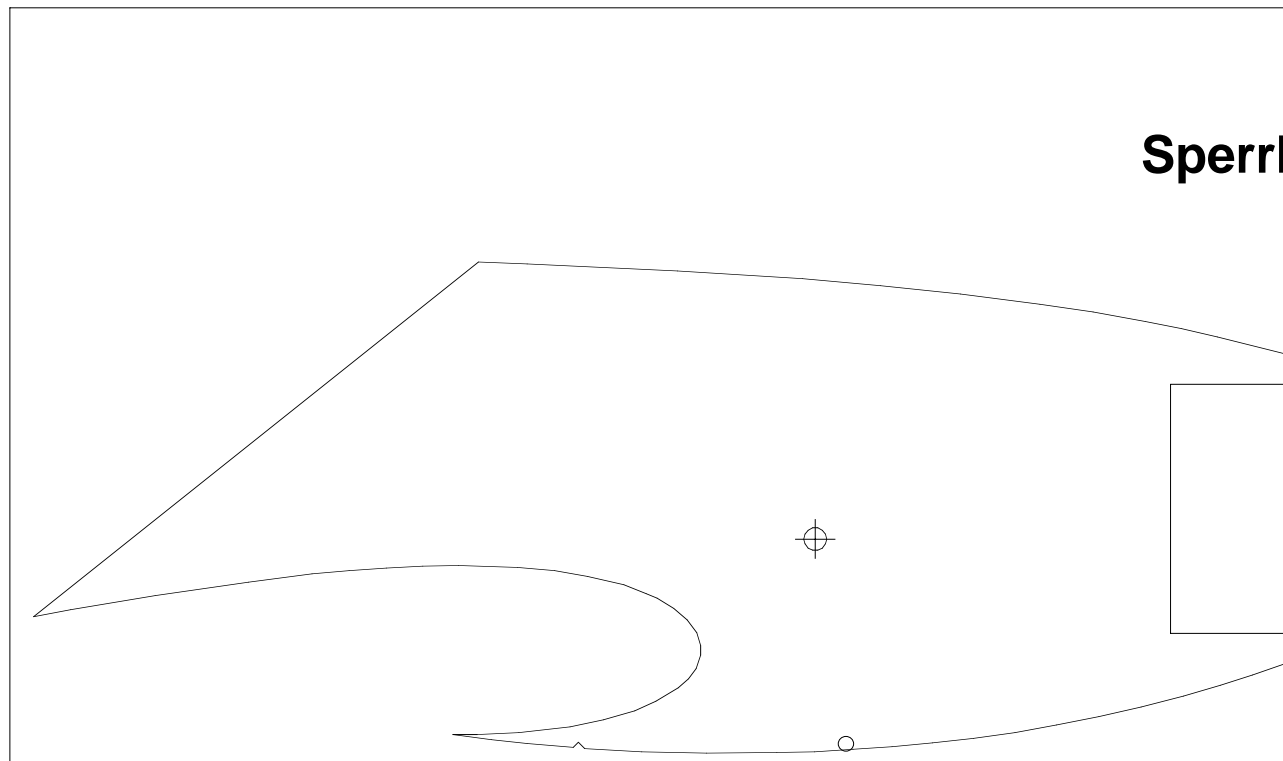

tolz 1mm

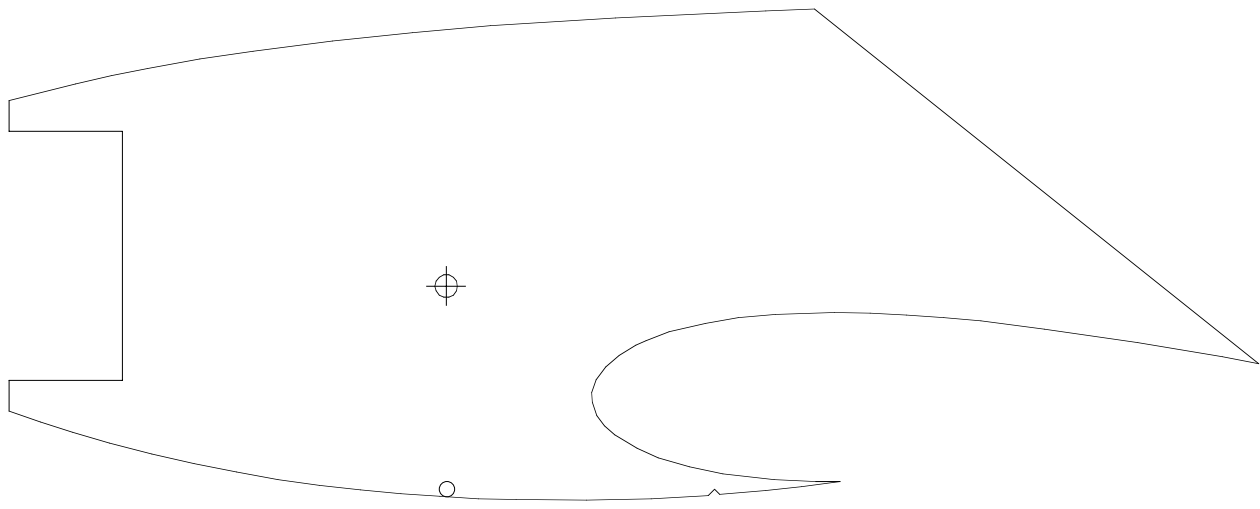

1

SP 2mm
Auflagerbrett für
Umlenkhebel

⊕
D=2mm

Sperrholz 2mm

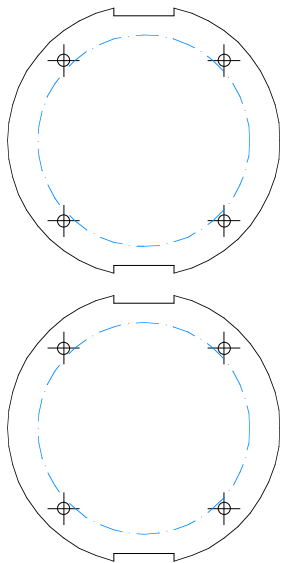

Aufnahme für Fahrgestell



SP 2mm

